

## FM EO2-Functional nut

for steel tubes

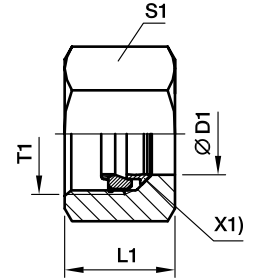

X1) Retaining ring

Series	Ø D1	T1	L1	S1	Order code				Weight g/1 piece
					FM... Steel, zinc plated Cr(VI) free passiv. +Sealing Sealing NBR	PN (bar)	FM...VIT Steel, zinc plated Cr(VI) free passiv. +Sealing Sealing FKM	PN (bar)	
LL	04	M 08×1.0	11.0	10	FM04LL	100		100	5
	06	M 10×1.0	11.5	12					6
L	06	M 12×1.5	14.5	14	FM06L	500	FM06LVIT	500	12
	08	M 14×1.5	14.5	17	FM08L	500	FM08LVIT	500	17
	10	M 16×1.5	15.5	19	FM10L	500	FM10LVIT	500	22
	12	M 18×1.5	15.5	22	FM12L	400	FM12LVIT	400	30
	15	M 22×1.5	17.0	27	FM15L	400	FM15LVIT	400	48
	18	M 26×1.5	18.0	32	FM18L	400	FM18LVIT	400	70
	22	M 30×2.0	20.0	36	FM22L	250	FM22LVIT	250	94
	28	M 36×2.0	21.0	41	FM28L	250	FM28LVIT	250	106
	35	M 45×2.0	24.0	50	FM35L	250	FM35LVIT	250	160
	42	M 52×2.0	24.0	60	FM42L	250	FM42LVIT	250	244
S	06	M 14×1.5	16.5	17	FM06S	800	FM06SVIT	800	20
	08	M 16×1.5	16.5	19	FM08S	800	FM08SVIT	800	23
	10	M 18×1.5	17.5	22	FM10S	800	FM10SVIT	800	37
	12	M 20×1.5	17.5	24	FM12S	630	FM12SVIT	630	39
	14	M 22×1.5	20.5	27	FM14S	630	FM14SVIT	630	60
	16	M 24×1.5	20.5	30	FM16S	630	FM16SVIT	630	72
	20	M 30×2.0	24.0	36	FM20S	420	FM20SVIT	420	121
	25	M 36×2.0	27.0	46	FM25S	420	FM25SVIT	420	221
	30	M 42×2.0	29.0	50	FM30S	420	FM30SVIT	420	248
	38	M 52×2.0	32.5	60	FM38S	420	FM38SVIT	420	367

## FM EO2-Functional nut

for stainless steel tubes

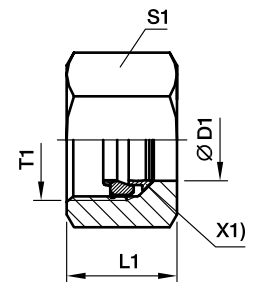

X1) Retaining ring

Series	Ø D1	T1	L1	S1	Order code								Weight g/1 piece
					FM...71 Stainless Steel		FM...NBR71 Stainless Steel		FM...SSA Steel, zinc plated Cr(VI) free passiv. +Sealing, Retaining ring: Stainless Steel		FM...VITSSA Steel, zinc plated Cr(VI) free passiv. +Sealing, Retaining ring: Stainless Steel		
					Sealing FKM	PN (bar)	Sealing NBR	PN (bar)	Sealing NBR	PN (bar)	Sealing FKM	PN (bar)	
LL	04	M 08×1.0	11.0	10					<b>FM04LLSSA</b>	100			5
	06	M 10×1.0	11.5	12					<b>FM06LLSSA</b>	100			6
L	06	M 12×1.5	14.5	14	<b>FM06L71</b>	315	<b>FM06LNBR71</b>	315	<b>FM06LSSA</b>	315	<b>FM06LVITSSA</b>	315	12
	08	M 14×1.5	14.5	17	<b>FM08L71</b>	315	<b>FM08LNBR71</b>	315	<b>FM08LSSA</b>	315	<b>FM08LVITSSA</b>	315	17
	10	M 16×1.5	15.5	19	<b>FM10L71</b>	315	<b>FM10LNBR71</b>	315	<b>FM10LSSA</b>	315	<b>FM10LVITSSA</b>	315	22
	12	M 18×1.5	15.5	22	<b>FM12L71</b>	315	<b>FM12LNBR71</b>	315	<b>FM12LSSA</b>	315	<b>FM12LVITSSA</b>	315	30
	15	M 22×1.5	17.0	27	<b>FM15L71</b>	315	<b>FM15LNBR71</b>	315	<b>FM15LSSA</b>	315	<b>FM15LVITSSA</b>	315	48
	18	M 26×1.5	18.0	32	<b>FM18L71</b>	315	<b>FM18LNBR71</b>	315	<b>FM18LSSA</b>	315	<b>FM18LVITSSA</b>	315	70
	22	M 30×2.0	20.0	36	<b>FM22L71</b>	160	<b>FM22LNBR71</b>	160	<b>FM22LSSA</b>	160	<b>FM22LVITSSA</b>	160	94
	28	M 36×2.0	21.0	41	<b>FM28L71</b>	160	<b>FM28LNBR71</b>	160	<b>FM28LSSA</b>	160	<b>FM28LVITSSA</b>	160	106
	35	M 45×2.0	24.0	50	<b>FM35L71</b>	160	<b>FM35LNBR71</b>	160	<b>FM35LSSA</b>	160	<b>FM35LVITSSA</b>	160	160
	42	M 52×2.0	24.0	60	<b>FM42L71</b>	160	<b>FM42LNBR71</b>	160	<b>FM42LSSA</b>	160	<b>FM42LVITSSA</b>	160	244
S	06	M 14×1.5	16.5	17	<b>FM06S71</b>	630	<b>FM06SNBR71</b>	630	<b>FM06SSSA</b>	630	<b>FM06SVITSSA</b>	630	20
	08	M 16×1.5	16.5	19	<b>FM08S71</b>	630	<b>FM08SNBR71</b>	630	<b>FM08SSSA</b>	630	<b>FM08SVITSSA</b>	630	23
	10	M 18×1.5	17.5	22	<b>FM10S71</b>	630	<b>FM10SNBR71</b>	630	<b>FM10SSSA</b>	630	<b>FM10SVITSSA</b>	630	37
	12	M 20×1.5	17.5	24	<b>FM12S71</b>	630	<b>FM12SNBR71</b>	630	<b>FM12SSSA</b>	630	<b>FM12SVITSSA</b>	630	39
	14	M 22×1.5	20.5	27	<b>FM14S71</b>	630	<b>FM14SNBR71</b>	630	<b>FM14SSSA</b>	630	<b>FM14SVITSSA</b>	630	60
	16	M 24×1.5	20.5	30	<b>FM16S71</b>	400	<b>FM16SNBR71</b>	400	<b>FM16SSSA</b>	400	<b>FM16SVITSSA</b>	400	72
	20	M 30×2.0	24.0	36	<b>FM20S71</b>	400	<b>FM20SNBR71</b>	400	<b>FM20SSSA</b>	400	<b>FM20SVITSSA</b>	400	121
	25	M 36×2.0	27.0	46	<b>FM25S71</b>	400	<b>FM25SNBR71</b>	400	<b>FM25SSSA</b>	400	<b>FM25SVITSSA</b>	400	221
	30	M 42×2.0	29.0	50	<b>FM30S71</b>	400	<b>FM30SNBR71</b>	400	<b>FM30SSSA</b>	400	<b>FM30SVITSSA</b>	400	248
	38	M 52×2.0	32.5	60	<b>FM38S71</b>	315	<b>FM38SNBR71</b>	315	<b>FM38SSSA</b>	315	<b>FM38SVITSSA</b>	315	367