

5125 / 5127 - SAE Straight flange adapter

SAE Flange / Butt weld tube end
(ISO 6162-1/-2)

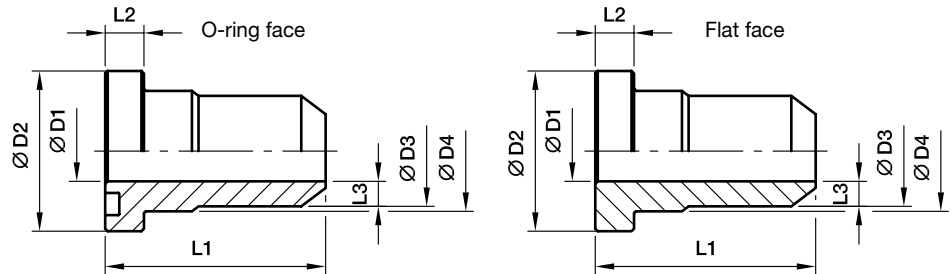

3000 PSI Series

Nom. flange size SAE (in.)	ISO (DN)	Ø Tube	D1	D2	D3	D4	L1	L2	L3	Weight (steel) kg/piece	O-ring face	Flat face	PN (bar)	
											Order code*	Order code*	S	SS
1/2	13	15×2.0	11	30.2	15	23.9	45.0	6.8	2.0	0.26	5125-015-08	5127-015-08	345	345
1/2	13	16×3.0	10	30.2	16	23.9	45.0	6.8	3.0	0.27	5125-016-08	5127-016-08	345	345
1/2	13	21.3×2.6	13	30.2	22	23.9	45.0	6.8	4.5	0.29	5125-021-08	5127-021-08	345	345
3/4	19	18×1.5	15	38.1	18	31.5	49.9	6.8	1.5	0.51	5125-018-12	5127-018-12	345	345
3/4	19	22×2.0	18	38.1	22	31.5	49.9	6.8	2.0	0.49	5125-022-12	5127-022-12	345	345
3/4	19	20×3.0	14	38.1	20	31.5	49.9	6.8	3.0	0.52	5125-020-12	5127-020-12	345	345
3/4	19	25×4.0	17	38.1	25	31.5	49.9	6.8	4.0	0.49	5125-025-12	5127-025-12	345	345
3/4	19	26.9×2.6	19	38.1	28	31.5	50.0	6.7	4.5	0.51	5125-027-12	5127-027-12	345	345
1	25	20×2.5	15	44.5	20	38.0	55.0	8.0	2.5	0.59	5125-020-16	5127-020-16	345	345
1	25	28×2.0	24	44.5	28	38.0	55.0	8.0	2.0	0.59	5125-028-16	5127-028-16	345	345
1	25	30×4.5	21	44.5	30	38.0	55.0	8.0	4.5	0.62	5125-030-16	5127-030-16	345	345
1	25	33.7×4.0	25	44.4	35	38.0	55.0	8.0	5.0	0.70	5125-034-16	5127-034-16	345	345
1 1/4	32	35×2.0	31	50.8	35	43.0	60.0	8.0	2.0	0.75	5125-035-20	5127-035-20	276	276
1 1/4	32	25×3.0	19	50.8	25	43.0	60.0	8.0	3.0	0.89	5125-025-20	5127-025-20	276	276
1 1/4	32	30×4.0	22	50.8	30	43.0	60.0	8.0	4.0	0.88	5125-030-20	5127-030-20	276	276
1 1/4	32	38×5.0	28	50.8	38	43.0	60.0	8.0	5.0	0.81	5125-038-20	5127-038-20	276	276
1 1/4	32	42.4×6.0	31	50.8	43	43.0	60.0	8.0	6.0	0.92	5125-042-20	5127-042-20	276	276
1 1/2	38	42×3.0	36	60.3	42	50.0	64.9	8.0	3.0	1.03	5125-042-24	5127-042-24	207	207
1 1/2	38	38×4.0	30	60.3	38	50.0	64.9	8.0	4.0	1.17	5125-038-24	5127-038-24	207	207
1 1/2	38	48.3×6.0	38	60.3	50	50.0	65.0	8.0	6.0	1.21	5125-048-24	5127-048-24	207	207
2	51	50×6.0	38	71.4	50	62.0	70.0	9.6	6.0	1.49	5125-050-32	5127-050-32	207	207
2	51	65×8.0	49	71.4	65	62.0	70.0	9.6	8.0	1.38	5125-065-32	5127-065-32	207	207
2	51	60.3×7.5	47	71.4	62	62.0	70.0	9.5	7.5	1.25	5125-060-32	5127-060-32	207	207
2 1/2	64	76.1×5.5	63	84.1	74	74.0	75.0	9.5	5.5	1.50	5125-076-40	5127-076-40	172	172
3	76	88.9×10.0	70	101.6	90	90.0	85.0	9.5	10.0	2.11	5125-090-48	5127-090-48	138	138
3 1/2	89	101.6×7.0	88	114.3	102	102.0	90.0	11.2	7.0	2.51	5125-100-56	5127-100-56	34	34
4	102	114×8.0	98	127.0	114	114.0	100.0	11.2	8.0	2.75	5125-114-64	5127-114-64	34	34
5	127	139.7×10.0	120	152.4	140	140.0	100.0	11.2	10.0	3.41	5125-140-80	5127-140-80	34	34

*Please add suffix **RVS** after partnumber if stainless steel is required.