

5161- Dowty seals for BSP and Metric

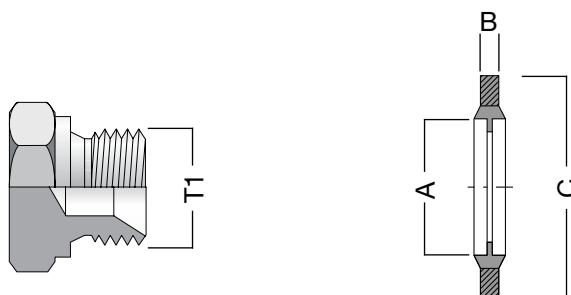

Order code		Thread (T1) BSP	A (mm)	B (mm)	C (mm)	burstpressure (bar)
Steel	Stainless Steel					
5161-02	5161-02RVS	1/8"	10.37	2.00	15.88	1500
5161-04	5161-04RVS	1/4"	13.74	2.00	20.57	1550
5161-06	5161-06RVS	3/8"	17.28	2.00	23.80	1260
5161-08	5161-08RVS	1/2"	21.54	2.50	28.58	1150
5161-10	5161-10RVS	5/8"	23.49	2.50	31.80	1250
5161-12	5161-12RVS	3/4"	27.05	2.50	34.93	1060
5161-16	5161-16RVS	1"	33.89	2.50	42.80	810
5161-20	5161-20RVS	1 1/4"	42.93	2.50	52.38	690
5161-24	5161-24RVS	1 1/2"	48.44	2.50	58.60	690
5161-32	5161-32RVS	2"	60.58	3.25	73.03	700
5161-40	5161-40RVS	2 1/2"	76.08	3.20	90.17	680

Order code		Thread (T1) Metric	A (mm)	B (mm)	C (mm)	burstpressure (bar)
Steel	Stainless Steel					
5162-04	5162-04RVS	M04	4.5	1.0	7.0	1250
5162-05	5162-05RVS	M05	5.7	1.0	10.0	1500
5162-06	5162-06RVS	M06	6.7	1.0	11.0	1510
5162-08	5162-08RVS	M08	8.7	1.0	13.0	1330
5162-10	5162-10RVS	M10	10.7	1.5	16.0	1350
5162-11	5162-11RVS	M11	11.8	1.5	19.1	1770
5162-12	5162-12RVS	M12	12.7	1.5	18.0	1250
5162-13	5162-13RVS	M13	13.7	1.5	22.0	1810
5162-14	5162-14RVS	M14	14.7	1.5	22.0	1510
5162-16	5162-16RVS	M16	16.7	1.5	24.0	1400
5162-17	5162-17RVS	M17	17.4	1.5	24.0	1150
5162-18	5162-18RVS	M18	18.7	1.5	26.0	1275
5162-20	5162-20RVS	M20	20.7	1.5	28.0	1150
5162-21	5162-21RVS	M21	21.5	2.5	28.6	1150
5162-22	5162-22RVS	M22	22.7	2.0	30.0	1100
5162-24	5162-24RVS	M24	24.7	2.0	32.0	1050
5162-26	5162-26RVS	M26	26.7	2.0	35.0	1050
5162-27	5162-27RVS	M27	27.2	2.0	36.0	1130
5162-30	5162-30RVS	M30	31.0	2.0	39.0	860
5162-33	5162-33RVS	M33	34.3	2.0	43.0	880
5162-36	5162-36RVS	M36	36.7	2.0	46.0	880
5162-42	5162-42RVS	M42	42.7	3.0	53.0	940
5162-48	5162-48RVS	M48	48.7	3.0	59.0	800
5162-52	5162-52RVS	M52	53.3	3.0	64.5	800