

GE-M-ED - Male stud connector

Male metric thread – ED (ISO 9974) / EO 24° cone end

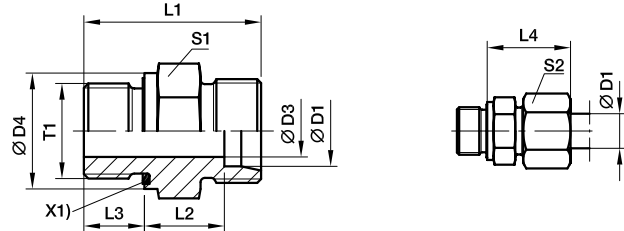

X1) Eolastic-sealing ED

Series	Ø D1	T1	D3	D4	L1	L2	L3	L4	S1	S2	Weight g/1 piece	Order code	PN (bar)	
													CF	71
L	06	M 10×1.0	4	14	23.5	8.5	8	23	14	14	13	GE06LMED	500	315
	08	M 12×1.5	6	17	29.0	10.0	12	25	17	17	22	GE08LMED	500	315
	10	M 14×1.5	7	19	30.0	11.0	12	26	19	19	29	GE10LMED	500	315
	10	M 12×1.5	6	17	30.0	11.0	12	26	17	19	23	GE10LM12X1.5ED	315	315
	10	M 16×1.5	8	22	31.5	12.5	12	24	22	19	40	GE10LM16X1.5ED	420	315
	10	M 18×1.5	8	24	31.5	12.5	12	27	24	19	50	GE10LM18X1.5ED	400	315
	10	M 22×1.5	8	27	35.0	14.0	14	29	27	19	80	GE10LM22X1.5ED	400	315
	12	M 16×1.5	9	22	31.5	12.5	12	27	22	22	40	GE12LMED	400	315
	12	M 14×1.5	7	19	30.0	11.0	12	26	19	22	30	GE12LM14X1.5ED	400	315
	12	M 18×1.5	10	24	31.5	12.5	12	27	24	22	47	GE12LM18X1.5ED	400	315
	12	M 22×1.5	10	27	35.0	14.0	14	29	27	22	75	GE12LM22X1.5ED	400	315
	15	M 18×1.5	11	24	32.5	13.5	12	29	24	27	51	GE15LMED	400	315
	15	M 16×1.5	9	22	32.0	13.0	12	28	24	27	64	GE15LM16X1.5ED	400	315
	15	M 22×1.5	12	27	36.0	15.0	14	30	27	27	77	GE15LM22X1.5ED	400	315
	18	M 22×1.5	14	27	36.0	14.5	14	31	27	32	74	GE18LMED	400	315
	18	M 18×1.5	11	24	33.5	14.0	12	30	27	32	68	GE18LM18X1.5ED	400	315
	22	M 26×1.5	18	32	40.0	16.5	16	33	32	36	103	GE22LMED	250	160
	22	M 22×1.5	14	32	38.0	16.5	14	33	32	36	97	GE22LM22X1.5ED	250	160
	28	M 33×2.0	23	40	43.0	17.5	18	34	41	41	168	GE28LMED	250	160
	35	M 42×2.0	30	50	48.0	17.5	20	39	50	50	281	GE35LMED	250	160
42	M 48×2.0	36	55	52.0	19.0	22	42	55	60	356	GE42LMED	250	160	
S	06	M 12×1.5	4	17	32.0	13.0	12	28	17	17	30	GE06SMED	800	630
	08	M 14×1.5	5	19	34.0	15.0	12	30	19	19	42	GE08SMED	800	630
	10	M 16×1.5	7	22	34.5	15.0	12	31	22	22	54	GE10SMED	800	630
	12	M 18×1.5	8	24	36.5	17.0	12	33	24	24	71	GE12SMED	630	630
	12	M 14×1.5	5	19	36.0	16.5	12	33	22	24	60	GE12SM14X1.5ED	630	630
	12	M 22×1.5	8	27	39.0	17.5	14	34	27	24	102	GE12SM22X1.5ED	630	400
	14	M 20×1.5	10	26	41.0	19.0	14	37	27	27	98	GE14SMED	630	630
	16	M 22×1.5	12	27	41.0	18.5	14	37	27	30	95	GE16SMED	630	400
	16	M 18×1.5	8	24	38.5	18.0	12	36	27	30	88	GE16SM18X1.5ED	630	400
	20	M 27×2.0	16	32	47.0	20.5	16	42	32	36	150	GE20SMED	420	400
	25	M 33×2.0	20	40	53.0	23.0	18	47	41	46	264	GE25SMED	420	400
	30	M 42×2.0	25	50	57.0	23.5	20	50	50	50	422	GE30SMED	420	400
	38	M 48×2.0	32	55	64.0	26.0	22	57	55	60	569	GE38SMED	420	315

Order code suffixes			
	Stainless Steel		Body Only
Suffix	71		OMD
Example	GE16SMED71		GE16SMEDOMD