

## EV-M-ED Assembled adjustable swivel 45° elbow

EO 24° cone end / Male metric thread – ED-seal (ISO 9974)

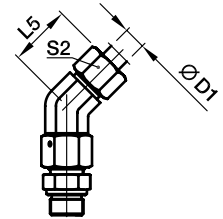
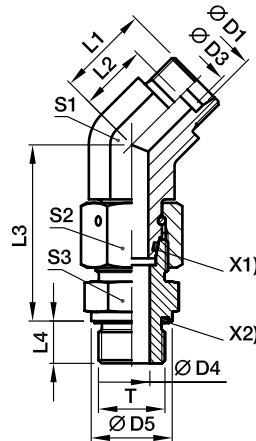

X1) O-ring OR  
X2) Eolastic-sealing ED

| Series          | D1<br>   | T        | D3 | D4 | D5   | L1   | L2   | L3   | L4 | L5 | S1 | S2 | S3   | Weight<br>g/1 piece | Order code*        | PN (bar) <sup>1)</sup> |     |
|-----------------|----------|----------|----|----|------|------|------|------|----|----|----|----|------|---------------------|--------------------|------------------------|-----|
|                 |          |          |    |    |      |      |      |      |    |    |    |    |      |                     |                    | CF                     | 71  |
| L <sup>3)</sup> | 06       | M 10×1.0 | 4  | 4  | 14   | 16.0 | 9.0  | 34.5 | 8  | 24 | 14 | 14 | 14   | 44                  | <b>EV06LMEDOMD</b> | 315                    | 315 |
|                 | 08       | M 12×1.5 | 6  | 6  | 17   | 19.0 | 12.0 | 37.5 | 12 | 27 | 14 | 17 | 17   | 62                  | <b>EV08LMEDOMD</b> | 315                    | 315 |
|                 | 10       | M 14×1.5 | 8  | 7  | 19   | 19.0 | 12.0 | 40.0 | 12 | 27 | 19 | 19 | 19   | 80                  | <b>EV10LMEDOMD</b> | 315                    | 315 |
|                 | 12       | M 16×1.5 | 10 | 9  | 22   | 21.0 | 14.0 | 42.0 | 12 | 29 | 19 | 22 | 22   | 110                 | <b>EV12LMEDOMD</b> | 315                    | 315 |
|                 | 15       | M 18×1.5 | 12 | 11 | 24   | 24.0 | 17.0 | 46.0 | 12 | 32 | 22 | 27 | 24   | 171                 | <b>EV15LMEDOMD</b> | 315                    | 315 |
|                 | 18       | M 22×1.5 | 15 | 14 | 27   | 24.0 | 16.5 | 50.0 | 14 | 33 | 27 | 32 | 27   | 245                 | <b>EV18LMEDOMD</b> | 315                    | 315 |
|                 | 22       | M 26×1.5 | 19 | 18 | 32   | 26.0 | 18.5 | 55.0 | 16 | 35 | 30 | 36 | 32   | 339                 | <b>EV22LMEDOMD</b> | 160                    | 160 |
|                 | 28       | M 33×2.0 | 24 | 23 | 40   | 30.5 | 23.0 | 59.0 | 18 | 40 | 36 | 41 | 41   | 517                 | <b>EV28LMEDOMD</b> | 160                    | 160 |
|                 | 35       | M 42×2.0 | 30 | 30 | 50   | 37.0 | 26.5 | 68.5 | 20 | 48 | 50 | 50 | 50   | 810                 | <b>EV35LMEDOMD</b> | 160                    | 160 |
|                 | 42       | M 48×2.0 | 36 | 36 | 55   | 37.0 | 26.0 | 75.0 | 22 | 49 | 50 | 60 | 55   | 1193                | <b>EV42LMEDOMD</b> | 160                    | 160 |
| S <sup>4)</sup> | 06       | M 12×1.5 | 4  | 4  | 17   | 16.0 | 9.0  | 40.0 | 12 | 24 | 14 | 17 | 17   | 72                  | <b>EV06SMEDOMD</b> | 630                    | 630 |
|                 | 08       | M 14×1.5 | 5  | 5  | 19   | 19.0 | 12.0 | 42.5 | 12 | 27 | 19 | 19 | 19   | 102                 | <b>EV08SMEDOMD</b> | 630                    | 630 |
|                 | 10       | M 16×1.5 | 7  | 7  | 22   | 21.0 | 13.5 | 45.0 | 12 | 30 | 19 | 22 | 22   | 132                 | <b>EV10SMEDOMD</b> | 630                    | 630 |
|                 | 12       | M 18×1.5 | 8  | 8  | 24   | 24.0 | 16.5 | 48.0 | 12 | 33 | 22 | 24 | 24   | 173                 | <b>EV12SMEDOMD</b> | 630                    | 630 |
|                 | 16       | M 22×1.5 | 12 | 12 | 27   | 24.0 | 15.5 | 55.0 | 14 | 34 | 27 | 30 | 27   | 284                 | <b>EV16SMEDOMD</b> | 400                    | 400 |
|                 | 20       | M 27×2.0 | 16 | 16 | 32   | 26.5 | 16.0 | 65.0 | 16 | 38 | 30 | 36 | 32   | 435                 | <b>EV20SMEDOMD</b> | 400                    | 400 |
|                 | 25       | M 33×2.0 | 20 | 20 | 40   | 30.5 | 18.5 | 73.0 | 18 | 43 | 36 | 46 | 41   | 790                 | <b>EV25SMEDOMD</b> | 400                    | 400 |
|                 | 30       | M 42×2.0 | 25 | 25 | 50   | 37.0 | 23.5 | 78.5 | 20 | 50 | 50 | 50 | 50   | 1132                | <b>EV30SMEDOMD</b> | 400                    | 400 |
| 38              | M 48×2.0 | 32       | 32 | 55 | 37.0 | 21.0 | 89.0 | 22   | 52 | 50 | 60 | 55 | 1631 | <b>EV38SMEDOMD</b>  | 315                | 315                    |     |

<sup>1)</sup> Pressure shown = item deliverable

<sup>3)</sup> L = light series; <sup>4)</sup> S = heavy series

$$\frac{\text{PN (bar)}}{10} = \text{PN (MPa)}$$

**Delivery without nut and ring. Information on ordering complete fittings or alternative sealing materials see page 17.**

\*Please add the **suffixes** below according to the material/surface required.

| Order code suffixes             |                             |               |   |
|---------------------------------|-----------------------------|---------------|---|
| Material                        | Suffix surface and material | Example       | Standard sealing material (no additional suffix needed) |
| Steel, zinc plated, Cr(VI)-free | CF                          | EV16SMEDOMDCF | NBR   |
| Stainless Steel                 | 71                          | EV16SMEDOMD71 | VIT   |