

## TE-M Male stud branch tee

EO 24° cone end / Male metric thread – metal sealing edge (ISO 9974)

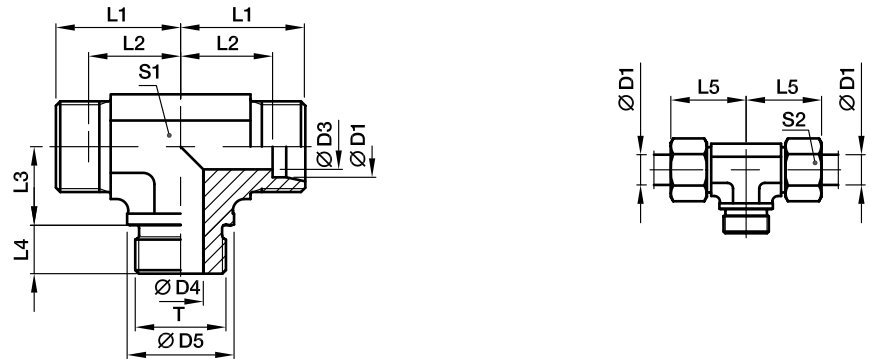

Series	D1	T	D3	D4	D5	L1	L2	L3	L4	L5	S1	S2	Weight g/1 piece	Order code*	PN (bar) <sup>1)</sup>	
															CF	71
L <sup>3)</sup>	22	M 26×1.5	19	18	31	35	27.5	26	16	44	27	36	208	<b>TE22LM</b>	160	160
	28	M 33×2.0	24	23	39	38	30.5	30	18	47	36	41	352	<b>TE28LM</b>	160	160
	35	M 42×2.0	30	30	49	45	34.5	34	20	56	41	50	554	<b>TE35LM</b>	160	160
	42	M 48×2.0	36	36	55	51	40.0	39	22	63	50	60	847	<b>TE42LM</b>	160	160
S <sup>4)</sup>	20	M 27×2.0	16	16	32	37	26.5	26	16	48	27	36	265	<b>TE20SM</b>	400	400
	25	M 33×2.0	20	20	39	42	30.0	30	18	54	36	46	482	<b>TE25SM</b>	250	250
	30	M 42×2.0	25	25	49	49	35.5	34	20	62	41	50	772	<b>TE30SM</b>	160	160
	38	M 48×2.0	32	32	55	57	41.0	39	22	72	50	60	1121	<b>TE38SM</b>	160	160

<sup>1)</sup> Pressure shown = item deliverable

<sup>3)</sup> L = light series; <sup>4)</sup> S = heavy series

$$\frac{\text{PN (bar)}}{10} = \text{PN (MPa)}$$

Delivery without nut and ring. Information on ordering complete fittings see page 17.

Order code suffixes		
Material	Suffix surface and material	Example
Steel, zinc plated, Cr(VI)-free	CFX	TE20SMCFX
Stainless Steel	71X	TE20SM71X

\*Please add the **suffixes** below according to the material/surface required.

### TE-R Male stud branch tee

EO 24° cone end / Male BSPP thread – metal sealing edge (ISO 1179)

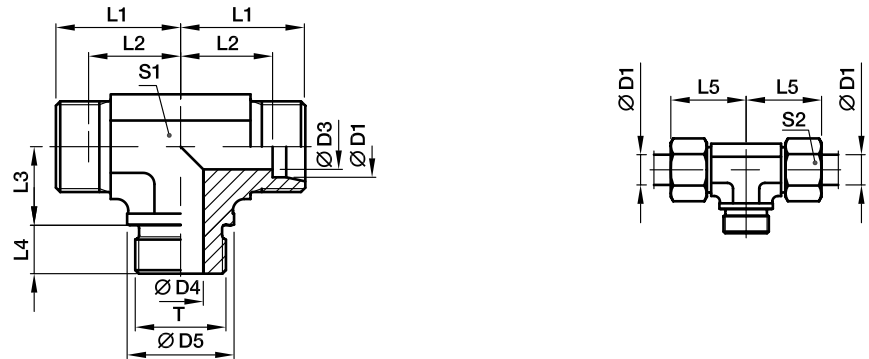

Series	D1	T	D3	D4	D5	L1	L2	L3	L4	L5	S1	S2	Weight g/1 piece	Order code*	PN (bar) <sup>1)</sup>		
															CF	71	MS
L <sup>3)</sup>	22	G 3/4 A	19	18	32	35	27.5	26	16	44	27	36	208	<b>TE22LR</b>	160	160	100
	28	G 1 A	24	23	39	38	30.5	30	18	47	36	41	378	<b>TE28LR</b>	160	160	100
	35	G 1 1/4 A	30	30	49	45	34.5	34	20	56	41	50	554	<b>TE35LR</b>	160	160	100
	42	G 1 1/2 A	36	36	55	51	40.0	39	22	63	50	60	847	<b>TE42LR</b>	160	160	100
S <sup>4)</sup>	20	G 3/4 A	16	16	32	37	26.5	26	16	48	27	36	267	<b>TE20SR</b>	400	400	250
	25	G 1 A	20	20	39	42	30.0	30	18	54	36	46	485	<b>TE25SR</b>	250	250	
	30	G 1 1/4 A	25	25	49	49	35.5	34	20	62	41	50	762	<b>TE30SR</b>	160	160	
	38	G 1 1/2 A	32	32	55	57	41.0	39	22	72	50	60	1121	<b>TE38SR</b>	160	160	

<sup>1)</sup> Pressure shown = item deliverable

<sup>3)</sup> L = light series; <sup>4)</sup> S = heavy series

$$\frac{PN \text{ (bar)}}{10} = PN \text{ (MPa)}$$

Delivery without nut and ring. Information on ordering complete fittings see page 17.

Order code suffixes		
Material	Suffix surface and material	Example
Steel, zinc plated, Cr(VI)-free	CFX	TE20SRCFX
Stainless Steel	71X	TE20SR71X
Brass	MSX	TE20SRMSX

\*Please add the **suffixes** below according to the material/surface required.