

Low Pressure Push-Lok®

The self-grip hose system for low-pressure applications

We're constantly updating our customer service options to help you work smarter, faster and better.

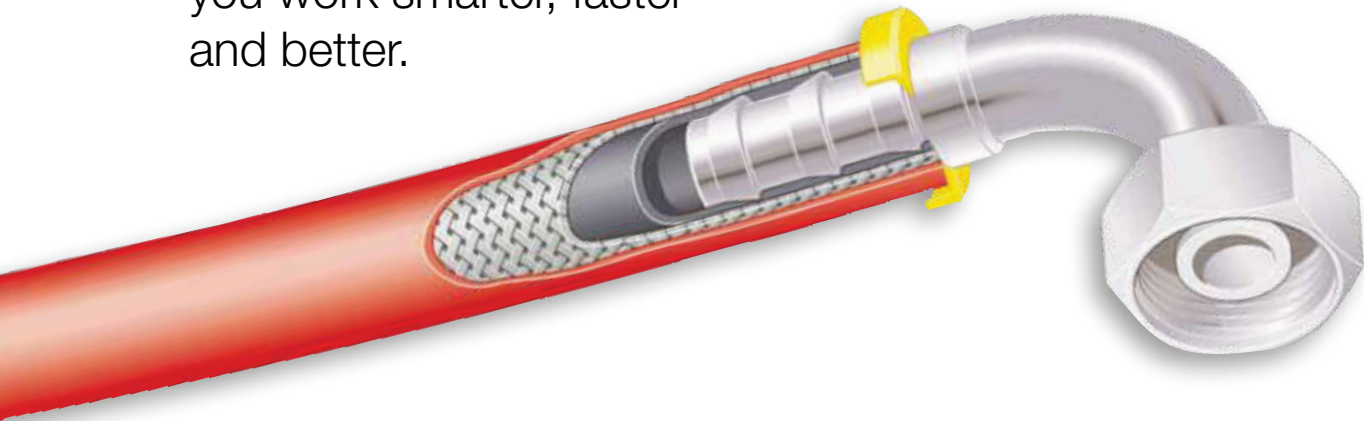

One fitting series for all hose types

with DIN, BSP, SAE, JIC and ORFS connections in brass, steel and stainless steel



Wide variety of hose types

6 rubber hose types

- 801Plus** for a variety of applications
- 804** for high-temperature water/phosphate ester fluids
- 821FR** with fire-retardant hose cover
- 831** ideal for petroleum-based fluids
- 836** for high oil temperatures
- 837BM** for a variety of applications including automotive

2 thermoplastic hose types

- 830M** for a variety of applications including automotive
- 838M** for non-conductive applications

1 hybrid hose type

- 837PU-Plus** for a variety of applications including automotive

Applications

Push-Lok® hoses offer variety, excellent performance and durability for the following applications



6 different colours

- easy identification
- simple production processes
 - one colour for one particular medium
- easy control of maintenance intervals
- simple stock planning in different departments

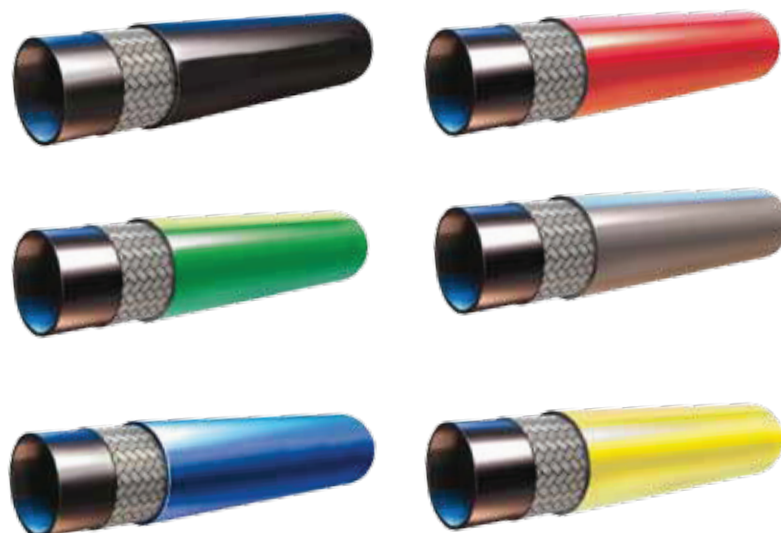

Easy assembly – no tools or clamps required

Push-Lok® assembly (1a, b)

- Cut the hose with a sharp knife
- Push the nipple into the hose – that's all!

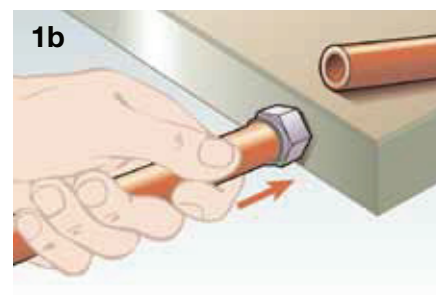

Push-Lok® disassembly (2a, b)

- Cut lengthwise along a line at approximately a 20° angle from the centre line of the hose. The cut should be approximately 2 cm long. Be careful not to nick barbs when cutting the hose.
- Grip hose and give a sharp downward tug to disengage from fitting.
- Before re-using the nipple, please check it for any damage.

