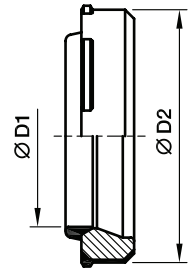

**DOZ EO-2 Soft sealing ring**

**Assembly direction:**  
Sealing lip shows to the tube end

| Series           | D1<br>          | D2   | Weight<br>g/1 piece | Order code     |                  |                        |                        |                    |
|------------------|-----------------|------|---------------------|----------------|------------------|------------------------|------------------------|--------------------|
|                  |                 |      |                     | Steel<br>NBR   | Steel<br>FKM     | Stainless Steel<br>FKM | Stainless Steel<br>NBR |                    |
| LL <sup>2)</sup> | 04              | 6.8  | 1                   | <b>DOZ04LL</b> | —                | —                      | —                      |                    |
|                  | 06              | 8.8  | 1                   | <b>DOZ06LL</b> | —                | —                      | —                      |                    |
| L <sup>3)</sup>  | 06              | 10.3 | 1                   | <b>DOZ06L</b>  | <b>DOZ06LVIT</b> | <b>DOZ06L71</b>        | <b>DOZ06LNBR71</b>     |                    |
|                  | 08              | 12.3 | 1                   | <b>DOZ08L</b>  | <b>DOZ08LVIT</b> | <b>DOZ08L71</b>        | <b>DOZ08LNBR71</b>     |                    |
|                  | 10              | 14.3 | 2                   | <b>DOZ10L</b>  | <b>DOZ10LVIT</b> | <b>DOZ10L71</b>        | <b>DOZ10LNBR71</b>     |                    |
|                  | 12              | 16.3 | 2                   | <b>DOZ12L</b>  | <b>DOZ12LVIT</b> | <b>DOZ12L71</b>        | <b>DOZ12LNBR71</b>     |                    |
|                  | 15              | 20.3 | 3                   | <b>DOZ15L</b>  | <b>DOZ15LVIT</b> | <b>DOZ15L71</b>        | <b>DOZ15LNBR71</b>     |                    |
|                  | 18              | 24.3 | 5                   | <b>DOZ18L</b>  | <b>DOZ18LVIT</b> | <b>DOZ18L71</b>        | <b>DOZ18LNBR71</b>     |                    |
|                  | 22              | 27.7 | 6                   | <b>DOZ22L</b>  | <b>DOZ22LVIT</b> | <b>DOZ22L71</b>        | <b>DOZ22LNBR71</b>     |                    |
|                  | 28              | 33.7 | 7                   | <b>DOZ28L</b>  | <b>DOZ28LVIT</b> | <b>DOZ28L71</b>        | <b>DOZ28LNBR71</b>     |                    |
|                  | 35              | 42.7 | 14                  | <b>DOZ35L</b>  | <b>DOZ35LVIT</b> | <b>DOZ35L71</b>        | <b>DOZ35LNBR71</b>     |                    |
|                  | 42              | 49.7 | 17                  | <b>DOZ42L</b>  | <b>DOZ42LVIT</b> | <b>DOZ42L71</b>        | <b>DOZ42LNBR71</b>     |                    |
|                  | S <sup>4)</sup> | 06   | 12.3                | 2              | <b>DOZ06S</b>    | <b>DOZ06SVIT</b>       | <b>DOZ06S71</b>        | <b>DOZ06SNBR71</b> |
|                  |                 | 08   | 14.3                | 2              | <b>DOZ08S</b>    | <b>DOZ08SVIT</b>       | <b>DOZ08S71</b>        | <b>DOZ08SNBR71</b> |
| 10               |                 | 16.3 | 3                   | <b>DOZ10S</b>  | <b>DOZ10SVIT</b> | <b>DOZ10S71</b>        | <b>DOZ10SNBR71</b>     |                    |
| 12               |                 | 18.3 | 4                   | <b>DOZ12S</b>  | <b>DOZ12SVIT</b> | <b>DOZ12S71</b>        | <b>DOZ12SNBR71</b>     |                    |
| 14               |                 | 20.3 | 4                   | <b>DOZ14S</b>  | <b>DOZ14SVIT</b> | <b>DOZ14S71</b>        | <b>DOZ14SNBR71</b>     |                    |
| 16               |                 | 22.3 | 5                   | <b>DOZ16S</b>  | <b>DOZ16SVIT</b> | <b>DOZ16S71</b>        | <b>DOZ16SNBR71</b>     |                    |
| 20               |                 | 27.7 | 9                   | <b>DOZ20S</b>  | <b>DOZ20SVIT</b> | <b>DOZ20S71</b>        | <b>DOZ20SNBR71</b>     |                    |
| 25               |                 | 33.7 | 13                  | <b>DOZ25S</b>  | <b>DOZ25SVIT</b> | <b>DOZ25S71</b>        | <b>DOZ25SNBR71</b>     |                    |
| 30               |                 | 39.7 | 18                  | <b>DOZ30S</b>  | <b>DOZ30SVIT</b> | <b>DOZ30S71</b>        | <b>DOZ30SNBR71</b>     |                    |
| 38               |                 | 49.7 | 27                  | <b>DOZ38S</b>  | <b>DOZ38SVIT</b> | <b>DOZ38S71</b>        | <b>DOZ38SNBR71</b>     |                    |

<sup>2)</sup> LL = very light series; <sup>3)</sup> L = light series; <sup>4)</sup> S = heavy series