

FM EO2-Functional nut

for steel tubes

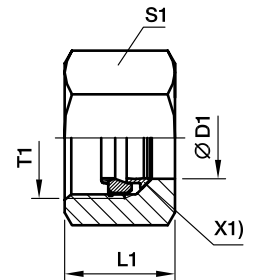

X1) Retaining ring

Series	Ø D1	T1	L1	S1	Order code				Weight g/1 piece
					FM... Steel, zinc plated Cr(VI) free passiv. +Sealing Sealing NBR	PN (bar)	FM...VIT Steel, zinc plated Cr(VI) free passiv. +Sealing Sealing FKM	PN (bar)	
LL	04	M 08×1.0	11.0	10	FM04LL	100		100	5
	06	M 10×1.0	11.5	12					6
L	06	M 12×1.5	14.5	14	FM06L	500	FM06LVIT	500	12
	08	M 14×1.5	14.5	17	FM08L	500	FM08LVIT	500	17
	10	M 16×1.5	15.5	19	FM10L	500	FM10LVIT	500	22
	12	M 18×1.5	15.5	22	FM12L	400	FM12LVIT	400	30
	15	M 22×1.5	17.0	27	FM15L	400	FM15LVIT	400	48
	18	M 26×1.5	18.0	32	FM18L	400	FM18LVIT	400	70
	22	M 30×2.0	20.0	36	FM22L	250	FM22LVIT	250	94
	28	M 36×2.0	21.0	41	FM28L	250	FM28LVIT	250	106
	35	M 45×2.0	24.0	50	FM35L	250	FM35LVIT	250	160
	42	M 52×2.0	24.0	60	FM42L	250	FM42LVIT	250	244
S	06	M 14×1.5	16.5	17	FM06S	800	FM06SVIT	800	20
	08	M 16×1.5	16.5	19	FM08S	800	FM08SVIT	800	23
	10	M 18×1.5	17.5	22	FM10S	800	FM10SVIT	800	37
	12	M 20×1.5	17.5	24	FM12S	630	FM12SVIT	630	39
	14	M 22×1.5	20.5	27	FM14S	630	FM14SVIT	630	60
	16	M 24×1.5	20.5	30	FM16S	630	FM16SVIT	630	72
	20	M 30×2.0	24.0	36	FM20S	420	FM20SVIT	420	121
	25	M 36×2.0	27.0	46	FM25S	420	FM25SVIT	420	221
	30	M 42×2.0	29.0	50	FM30S	420	FM30SVIT	420	248
	38	M 52×2.0	32.5	60	FM38S	420	FM38SVIT	420	367

FM EO2-Functional nut

for stainless steel tubes

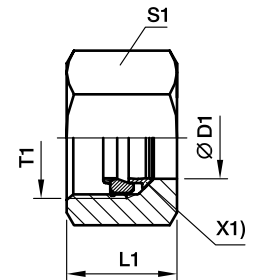

X1) Retaining ring

Series	Ø D1	T1	L1	S1	Order code								Weight g/1 piece
					FM...71 Stainless Steel		FM...NBR71 Stainless Steel		FM...SSA Steel, zinc plated Cr(VI) free passiv. +Sealing, Retaining ring: Stainless Steel		FM...VITSSA Steel, zinc plated Cr(VI) free passiv. +Sealing, Retaining ring: Stainless Steel		
					Sealing FKM	PN (bar)	Sealing NBR	PN (bar)	Sealing NBR	PN (bar)	Sealing FKM	PN (bar)	
LL	04	M 08×1.0	11.0	10					FM04LLSSA	100			5
	06	M 10×1.0	11.5	12					FM06LLSSA	100			6
L	06	M 12×1.5	14.5	14	FM06L71	315	FM06LNBR71	315	FM06LSSA	315	FM06LVITSSA	315	12
	08	M 14×1.5	14.5	17	FM08L71	315	FM08LNBR71	315	FM08LSSA	315	FM08LVITSSA	315	17
	10	M 16×1.5	15.5	19	FM10L71	315	FM10LNBR71	315	FM10LSSA	315	FM10LVITSSA	315	22
	12	M 18×1.5	15.5	22	FM12L71	315	FM12LNBR71	315	FM12LSSA	315	FM12LVITSSA	315	30
	15	M 22×1.5	17.0	27	FM15L71	315	FM15LNBR71	315	FM15LSSA	315	FM15LVITSSA	315	48
	18	M 26×1.5	18.0	32	FM18L71	315	FM18LNBR71	315	FM18LSSA	315	FM18LVITSSA	315	70
	22	M 30×2.0	20.0	36	FM22L71	160	FM22LNBR71	160	FM22LSSA	160	FM22LVITSSA	160	94
	28	M 36×2.0	21.0	41	FM28L71	160	FM28LNBR71	160	FM28LSSA	160	FM28LVITSSA	160	106
	35	M 45×2.0	24.0	50	FM35L71	160	FM35LNBR71	160	FM35LSSA	160	FM35LVITSSA	160	160
	42	M 52×2.0	24.0	60	FM42L71	160	FM42LNBR71	160	FM42LSSA	160	FM42LVITSSA	160	244
S	06	M 14×1.5	16.5	17	FM06S71	630	FM06SNBR71	630	FM06SSSA	630	FM06SVITSSA	630	20
	08	M 16×1.5	16.5	19	FM08S71	630	FM08SNBR71	630	FM08SSSA	630	FM08SVITSSA	630	23
	10	M 18×1.5	17.5	22	FM10S71	630	FM10SNBR71	630	FM10SSSA	630	FM10SVITSSA	630	37
	12	M 20×1.5	17.5	24	FM12S71	630	FM12SNBR71	630	FM12SSSA	630	FM12SVITSSA	630	39
	14	M 22×1.5	20.5	27	FM14S71	630	FM14SNBR71	630	FM14SSSA	630	FM14SVITSSA	630	60
	16	M 24×1.5	20.5	30	FM16S71	400	FM16SNBR71	400	FM16SSSA	400	FM16SVITSSA	400	72
	20	M 30×2.0	24.0	36	FM20S71	400	FM20SNBR71	400	FM20SSSA	400	FM20SVITSSA	400	121
	25	M 36×2.0	27.0	46	FM25S71	400	FM25SNBR71	400	FM25SSSA	400	FM25SVITSSA	400	221
	30	M 42×2.0	29.0	50	FM30S71	400	FM30SNBR71	400	FM30SSSA	400	FM30SVITSSA	400	248
	38	M 52×2.0	32.5	60	FM38S71	315	FM38SNBR71	315	FM38SSSA	315	FM38SVITSSA	315	367