

MAVE - Pressure gauge swivel connector

Female BSPP thread / EO 24° DKO swivel

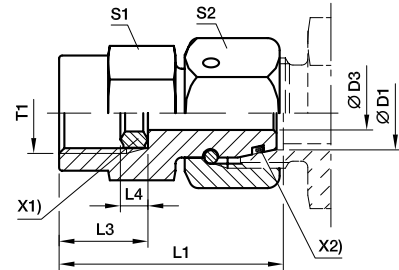

X1) Sealing-ring DK1
X2) O-ring OR

| Series | Ø D1 | T1 | D3 | L1 | L3 | L4 | S1 | S2 | Weight g/1 piece | Order code | PN (bar) ¹⁾ | |
|--------|------|-------|-----|------|------|-----|----|----|------------------|-------------|------------------------|-----|
| | | | | | | | | | | | CF | 71 |
| L | 06 | G 1/4 | 2.5 | 35.5 | 14.5 | 4.5 | 19 | 14 | 46 | MAVE06LR | 500 | 315 |
| | 08 | G 1/4 | 4.0 | 35.5 | 14.5 | 4.5 | 19 | 17 | 52 | MAVE08LR | 500 | 315 |
| | 10 | G 1/4 | 5.5 | 36.0 | 14.5 | 4.5 | 19 | 19 | 59 | MAVE10LR | 500 | 315 |
| | 12 | G 1/4 | 5.5 | 36.0 | 14.5 | 4.5 | 19 | 22 | 70 | MAVE12LR | 400 | 315 |
| S | 06 | G 1/2 | 2.5 | 42.5 | 20.0 | 5.0 | 27 | 17 | 95 | MAVE06SR | 630 | 630 |
| | 06 | G 1/4 | 2.5 | 35.5 | 14.5 | 4.5 | 19 | 17 | 52 | MAVE06SR1/4 | 630 | 630 |
| | 08 | G 1/2 | 4.0 | 43.0 | 20.0 | 5.0 | 27 | 19 | 100 | MAVE08SR | 630 | 630 |
| | 08 | G 1/4 | 4.0 | 35.5 | 14.5 | 4.5 | 19 | 19 | 58 | MAVE08SR1/4 | 630 | 630 |
| | 10 | G 1/2 | 6.0 | 43.5 | 20.0 | 5.0 | 27 | 22 | 109 | MAVE10SR | 630 | 630 |
| | 10 | G 1/4 | 7.0 | 39.0 | 14.5 | 4.5 | 19 | 22 | 67 | MAVE10SR1/4 | 630 | 630 |
| | 12 | G 1/2 | 7.0 | 45.0 | 20.0 | 5.0 | 27 | 24 | 125 | MAVE12SR | 630 | 630 |
| | 12 | G 1/4 | 7.0 | 39.0 | 14.5 | 4.5 | 19 | 24 | 83 | MAVE12SR1/4 | 630 | 630 |

| Order code suffixes | | | |
|---------------------|-----------------|--|--|
| | Stainless Steel | | |
| Suffix | 71 | | |
| Example | MAVE08LR71 | | |