

## GZ Swivel union

EO 24° DKO swivel

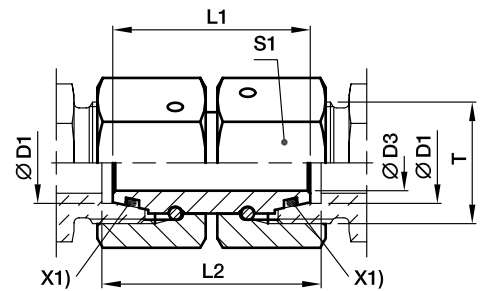

X1) O-ring OR

Series	D1 	T	D3	L1	L2	S1	Weight g/1 piece	Order code*	PN (bar) <sup>1)</sup>	
									CF	71
L <sup>3)</sup>	06	M 12×1.5	2.5	32	32	14	28	<b>GZ06L</b>	500	315
	08	M 14×1.5	4.0	32	32	17	41	<b>GZ08L</b>	500	315
	10	M 16×1.5	6.0	33	33	19	53	<b>GZ10L</b>	500	315
	12	M 18×1.5	8.0	33	33	22	71	<b>GZ12L</b>	400	315
	15	M 22×1.5	10.0	38	38	27	129	<b>GZ15L</b>	400	315
	18	M 26×1.5	13.0	36	38	32	165	<b>GZ18L</b>	400	315
	22	M 30×2.0	17.0	42	44	36	243	<b>GZ22L</b>	250	160
	28	M 36×2.0	22.0	46	48	41	319	<b>GZ28L</b>	250	160
S <sup>4)</sup>	06	M 14×1.5	2.5	32	33	17	41	<b>GZ06S</b>	800	630
	08	M 16×1.5	4.0	33	34	19	54	<b>GZ08S</b>	800	630
	10	M 18×1.5	6.0	33	35	22	74	<b>GZ10S</b>	800	630
	12	M 20×1.5	8.0	36	38	24	95	<b>GZ12S</b>	630	630
	14	M 22×1.5	9.0	39	41	27	131	<b>GZ14S</b>	630	630
	16	M 24×1.5	11.0	39	42	30	172	<b>GZ16S</b>	630	400
	20	M 30×2.0	14.0	44	48	36	261	<b>GZ20S</b>	420	400
	25	M 36×2.0	18.0	46	53	46	477	<b>GZ25S</b>	420	400
	30	M 42×2.0	23.0	52	62	50	605	<b>GZ30S</b>	420	400
	38	M 52×2.0	30.0	52	67	60	826	<b>GZ38S</b>	420	315

<sup>1)</sup> Pressure shown = item deliverable

<sup>3)</sup> L = light series; <sup>4)</sup> S = heavy series

$$\frac{PN \text{ (bar)}}{10} = PN \text{ (MPa)}$$

Information on ordering complete fittings or alternative sealing materials see page 17.

\*Please add the **suffixes** below according to the material/surface required.

Order code suffixes			
Material	Suffix surface and material	Example	Standard sealing material (no additional suffix needed)
Steel, zinc plated, Cr(VI)-free	CF	GZ16SCF	NBR
Stainless Steel	71	GZ16S71	VIT