

GE-R - Male stud connector

Male BSPP thread – metal sealing edge (ISO 1179) / EO 24° cone end

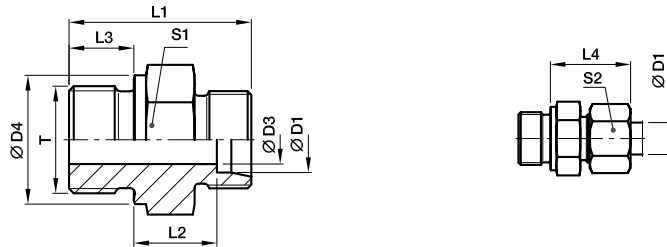

| Series | Ø D1 | T | D3 | D4 | L1 | L2 | L3 | L4 | S1 | S2 | Weight g/1 piece | Order code | PN (bar) | | |
|--------|-----------|-----------|----|------|------|------|------|------|----|-----|------------------|------------|----------|-----|-----|
| | | | | | | | | | | | | | CF | 71 | MS |
| L | 06 | G 1/8 A | 4 | 14 | 23.5 | 8.5 | 8 | 23.0 | 14 | 14 | 14 | GE06LR | 315 | 315 | 200 |
| | 06 | G 1/4 A | 4 | 18 | 29.0 | 10.0 | 12 | 25.0 | 19 | 14 | 60 | GE06LR1/4 | 315 | 315 | 200 |
| | 06 | G 3/8 A | 4 | 22 | 30.5 | 11.5 | 12 | 26.0 | 22 | 14 | 45 | GE06LR3/8 | 315 | 315 | 200 |
| | 06 | G 1/2 A | 4 | 26 | 33.0 | 12.0 | 14 | 27.0 | 27 | 14 | 60 | GE06LR1/2 | 315 | 315 | 200 |
| | 08 | G 1/4 A | 6 | 18 | 29.0 | 10.0 | 12 | 25.0 | 19 | 17 | 26 | GE08LR | 315 | 315 | 200 |
| | 08 | G 1/8 A | 4 | 14 | 24.5 | 8.5 | 8 | 23.0 | 14 | 17 | 16 | GE08LR1/8 | 315 | 315 | 200 |
| | 08 | G 3/8 A | 6 | 22 | 30.5 | 11.5 | 12 | 26.0 | 22 | 17 | 44 | GE08LR3/8 | 315 | 315 | 200 |
| | 08 | G 1/2 A | 6 | 26 | 33.0 | 12.0 | 14 | 27.0 | 27 | 17 | 74 | GE08LR1/2 | 315 | 315 | 200 |
| | 10 | G 1/4 A | 6 | 18 | 30.0 | 11.0 | 12 | 26.0 | 19 | 19 | 31 | GE10LR | 315 | 315 | 200 |
| | 10 | G 1/8 A | 4 | 14 | 25.5 | 10.5 | 8 | 25.0 | 17 | 19 | 21 | GE10LR1/8 | 315 | 315 | 200 |
| | 10 | G 3/8 A | 8 | 22 | 31.5 | 12.5 | 12 | 27.0 | 22 | 19 | 44 | GE10LR3/8 | 315 | 315 | 200 |
| | 10 | G 1/2 A | 8 | 26 | 34.0 | 13.0 | 14 | 28.0 | 27 | 19 | 72 | GE10LR1/2 | 315 | 315 | 200 |
| | 12 | G 3/8 A | 9 | 22 | 31.5 | 12.5 | 12 | 27.0 | 22 | 22 | 43 | GE12LR | 315 | 315 | 200 |
| | 12 | G 1/8 A | 4 | 14 | 26.5 | 11.5 | 8 | 26.0 | 19 | 22 | 27 | GE12LR1/8 | 315 | 315 | 200 |
| | 12 | G 1/4 A | 6 | 18 | 31.0 | 12.0 | 12 | 27.0 | 19 | 22 | 32 | GE12LR1/4 | 315 | 315 | 200 |
| | 12 | G 1/2 A | 10 | 26 | 34.0 | 13.0 | 14 | 28.0 | 27 | 22 | 67 | GE12LR1/2 | 315 | 315 | 200 |
| | 12 | G 3/4 A | 10 | 32 | 37.0 | 14.0 | 16 | 29.0 | 32 | 22 | 120 | GE12LR3/4 | 315 | 315 | 200 |
| | 15 | G 1/2 A | 11 | 26 | 35.0 | 14.0 | 14 | 29.0 | 27 | 27 | 72 | GE15LR | 250 | 250 | 160 |
| | 15 | G 3/8 A | 9 | 22 | 32.5 | 13.5 | 12 | 29.0 | 24 | 27 | 56 | GE15LR3/8 | 250 | 250 | 160 |
| | 15 | G 3/4 A | 12 | 32 | 38.0 | 15.0 | 16 | 30.0 | 32 | 27 | 118 | GE15LR3/4 | 250 | 250 | 160 |
| | 18 | G 1/2 A | 14 | 26 | 36.0 | 14.5 | 14 | 31.0 | 27 | 32 | 72 | GE18LR | 250 | 250 | 160 |
| | 18 | G 3/8 A | 9 | 22 | 33.5 | 14.0 | 12 | 29.5 | 27 | 32 | 69 | GE18LR3/8 | 250 | 250 | 160 |
| | 18 | G 3/4 A | 15 | 32 | 38.0 | 14.5 | 16 | 30.0 | 32 | 32 | 112 | GE18LR3/4 | 250 | 250 | 160 |
| | 22 | G 3/4 A | 18 | 32 | 40.0 | 16.5 | 16 | 33.0 | 32 | 36 | 103 | GE22LR | 160 | 160 | 100 |
| | 22 | G 1/2 A | 14 | 26 | 38.0 | 16.5 | 14 | 33.0 | 32 | 36 | 91 | GE22LR1/2 | 160 | 160 | 100 |
| | 22 | G 1 A | 19 | 39 | 43.0 | 17.5 | 18 | 33.5 | 41 | 36 | 184 | GE22LR1 | 160 | 160 | 100 |
| | 28 | G 1 A | 23 | 39 | 43.0 | 17.5 | 18 | 34.0 | 41 | 41 | 168 | GE28LR | 160 | 160 | 100 |
| | 28 | G 1/2 A | 14 | 26 | 39.0 | 17.5 | 14 | 34.0 | 41 | 41 | 141 | GE28LR1/2 | 160 | 160 | 100 |
| | 28 | G 3/4 A | 18 | 32 | 41.0 | 17.5 | 16 | 34.0 | 41 | 41 | 156 | GE28LR3/4 | 160 | 160 | 100 |
| | 28 | G 1 1/4 A | 24 | 50 | 46.0 | 18.3 | 20 | 35.0 | 50 | 41 | 314 | GE28LR11/4 | 160 | 160 | 100 |
| | 35 | G 1 1/4 A | 30 | 49 | 48.0 | 17.5 | 20 | 39.0 | 50 | 50 | 276 | GE35LR | 160 | 160 | 100 |
| | 35 | G 1/2 A | 14 | 26 | 42.0 | 17.5 | 14 | 39.0 | 46 | 50 | 194 | GE35LR1/2 | 160 | 160 | 100 |
| 35 | G 3/4 A | 18 | 32 | 44.0 | 17.5 | 16 | 39.0 | 46 | 50 | 202 | GE35LR3/4 | 160 | 160 | 100 | |
| 35 | G 1 A | 23 | 39 | 46.0 | 17.5 | 18 | 39.0 | 46 | 50 | 234 | GE35LR1 | 160 | 160 | 100 | |
| 35 | G 1 1/2 A | 30 | 55 | 52.0 | 19.5 | 22 | 41.0 | 55 | 50 | 355 | GE35LR11/2 | 160 | 160 | 100 | |
| 42 | G 1 1/2 A | 36 | 55 | 52.0 | 19.0 | 22 | 42.0 | 55 | 60 | 349 | GE42LR | 160 | 160 | 100 | |
| 42 | G 1 A | 23 | 39 | 48.0 | 19.0 | 18 | 42.0 | 55 | 60 | 327 | GE42LR1 | 160 | 160 | 100 | |
| 42 | G 1 1/4 A | 30 | 49 | 50.0 | 19.0 | 20 | 42.0 | 55 | 60 | 336 | GE42LR11/4 | 160 | 160 | 100 | |

continued on next page...

| Order code suffixes | | | |
|---------------------|-----------------|----------|-----------|
| | Stainless Steel | Brass | Body Only |
| Suffix | 71 | MS | X |
| Example | GE15LR71 | GE15LRMS | GE15LRX |

GE-R - Male stud connector

Male BSPP thread – metal sealing edge (ISO 1179) / EO 24° cone end

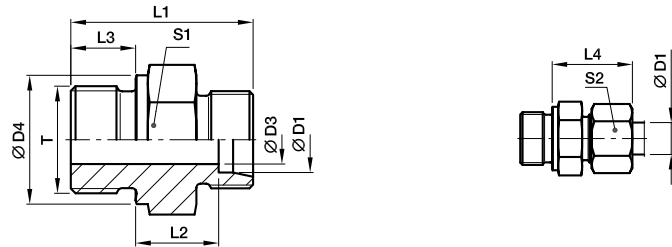

| Series | Ø D1 | T | D3 | D4 | L1 | L2 | L3 | L4 | S1 | S2 | Weight g/1 piece | Order code | PN (bar) | | |
|--------|------|-----------|----|----|------|------|----|----|----|----|------------------|------------|----------|-----|-----|
| | | | | | | | | | | | | | CF | 71 | MS |
| S | 06 | G 1/4 A | 4 | 18 | 32.0 | 13.0 | 12 | 28 | 19 | 17 | 35 | GE06SR | 400 | 400 | 250 |
| | 06 | G 1/8 A | 3 | 14 | 27.5 | 12.5 | 8 | 27 | 14 | 17 | 22 | GE06SR1/8 | 400 | 400 | |
| | 06 | G 3/8 A | 4 | 22 | 34.5 | 15.5 | 12 | 30 | 22 | 17 | 57 | GE06SR3/8 | 400 | 400 | |
| | 06 | G 1/2 A | 4 | 26 | 39.0 | 18.0 | 14 | 33 | 27 | 17 | 83 | GE06SR1/2 | 400 | 400 | |
| | 08 | G 1/4 A | 5 | 18 | 34.0 | 15.0 | 12 | 30 | 19 | 19 | 41 | GE08SR | 400 | 400 | 250 |
| | 08 | G 3/8 A | 5 | 22 | 34.5 | 15.5 | 12 | 30 | 22 | 19 | 59 | GE08SR3/8 | 400 | 400 | |
| | 08 | G 1/2 A | 5 | 26 | 39.0 | 18.0 | 14 | 33 | 27 | 19 | 100 | GE08SR1/2 | 400 | 400 | |
| | 10 | G 3/8 A | 7 | 22 | 34.5 | 15.0 | 12 | 31 | 22 | 22 | 56 | GE10SR | 400 | 400 | 250 |
| | 10 | G 1/4 A | 5 | 18 | 34.0 | 14.5 | 12 | 31 | 19 | 22 | 43 | GE10SR1/4 | 400 | 400 | |
| | 10 | G 1/2 A | 7 | 26 | 39.0 | 17.5 | 14 | 34 | 27 | 22 | 97 | GE10SR1/2 | 400 | 400 | |
| | 12 | G 3/8 A | 8 | 22 | 36.5 | 17.0 | 12 | 33 | 22 | 24 | 62 | GE12SR | 400 | 400 | 250 |
| | 12 | G 1/4 A | 5 | 18 | 36.0 | 16.5 | 12 | 33 | 22 | 24 | 57 | GE12SR1/4 | 400 | 400 | |
| | 12 | G 1/2 A | 8 | 26 | 39.0 | 17.5 | 14 | 34 | 27 | 24 | 57 | GE12SR1/2 | 400 | 400 | |
| | 14 | G 1/2 A | 10 | 26 | 41.0 | 19.0 | 14 | 37 | 27 | 27 | 96 | GE14SR | 400 | 400 | 250 |
| | 14 | G 3/8 A | 8 | 22 | 38.5 | 18.5 | 12 | 36 | 24 | 27 | 74 | GE14SR3/8 | 400 | 400 | |
| | 16 | G 1/2 A | 12 | 26 | 41.0 | 18.5 | 14 | 37 | 27 | 30 | 92 | GE16SR | 400 | 400 | 250 |
| | 16 | G 3/8 A | 8 | 22 | 38.5 | 18.0 | 12 | 36 | 27 | 30 | 83 | GE16SR3/8 | 400 | 400 | |
| | 16 | G 3/4 A | 12 | 32 | 45.0 | 20.5 | 16 | 39 | 32 | 30 | 157 | GE16SR3/4 | 400 | 400 | |
| | 20 | G 3/4 A | 16 | 32 | 47.0 | 20.5 | 16 | 42 | 32 | 36 | 151 | GE20SR | 400 | 400 | 250 |
| | 20 | G 1/2 A | 12 | 26 | 45.0 | 20.5 | 14 | 42 | 32 | 36 | 142 | GE20SR1/2 | 400 | 400 | |
| | 20 | G 1 A | 16 | 39 | 51.0 | 22.5 | 18 | 44 | 41 | 36 | 273 | GE20SR1 | 250 | 250 | |
| | 20 | G 1 1/4 A | 16 | 49 | 53.0 | 22.5 | 20 | 44 | 50 | 36 | 387 | GE20SR11/4 | 160 | 160 | |
| | 25 | G 1 A | 20 | 39 | 53.0 | 23.0 | 18 | 47 | 41 | 46 | 267 | GE25SR | 250 | 250 | 160 |
| | 25 | G 3/4 A | 16 | 32 | 51.0 | 23.0 | 16 | 47 | 41 | 46 | 245 | GE25SR3/4 | 250 | 250 | |
| | 25 | G 1 1/4 A | 20 | 49 | 55.0 | 23.0 | 20 | 47 | 50 | 46 | 422 | GE25SR11/4 | 160 | 160 | |
| | 30 | G 1 1/4 A | 25 | 49 | 57.0 | 23.5 | 20 | 50 | 50 | 50 | 422 | GE30SR | 160 | 160 | 100 |
| | 30 | G 1 A | 20 | 39 | 55.0 | 23.5 | 18 | 50 | 46 | 50 | 337 | GE30SR1 | 160 | 160 | |
| | 38 | G 1 1/2 A | 32 | 55 | 64.0 | 26.0 | 22 | 57 | 55 | 60 | 560 | GE38SR | 160 | 160 | 100 |
| | 38 | G 1 1/4 A | 25 | 49 | 62.0 | 26.0 | 20 | 57 | 55 | 60 | 578 | GE38SR11/4 | 160 | 160 | |

| Order code suffixes | | | |
|---------------------|-----------------|----------|-----------|
| | Stainless Steel | Brass | Body Only |
| Suffix | 71 | MS | X |
| Example | GE16SR71 | GE16SRMS | GE16SRX |