

## F42EDMLO Male stud connector

O-Lok® ORFS tube end / Male BSPP thread – ED seal (ISO 1179)

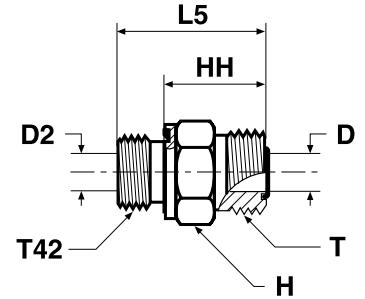

Tube O.D.		BSPP male thread T42	Thread UN/UNF-2A T	D mm	D2 mm	H mm	HH mm	L5 mm	Weight (steel) g/1 piece	O-Lok® Steel	O-Lok® Stainless Steel	PN (bar)	
mm	in.											S	SS
6	1/4	1/8-28	9/16-18	4.5	4	17	18	26	29	<b>4F42EDMLOS</b>	<b>4F42EDMLOSS</b>	630	630
6	1/4	1/4-19	9/16-18	4.5	4.5	19	19	31	42	<b>4-4F42EDMLOS</b>	<b>4-4F42EDMLOSS</b>	630	630
6	1/4	3/8-19	9/16-18	4.5	4.5	22	20	32	61	<b>4-6F42EDMLOS</b>	<b>4-6F42EDMLOSS</b>	630	630
6	1/4	1/2-14	9/16-18	4.5	4.5	27	22	36	119	<b>4-8F42EDMLOS</b>	<b>4-8F42EDMLOSS</b>	420	420
8, 10	5/16, 3/8	1/4-19	11/16-16	6.5	5	19	20	32	45	<b>6F42EDMLOS</b>	<b>6F42EDMLOSS</b>	630	630
8, 10	5/16, 3/8	1/8-28	11/16-16	6.5	4	19	23	31	44	<b>6-2F42EDMLOS</b>	<b>6-2F42EDMLOSS</b>	630	630
8, 10	5/16, 3/8	3/8-19	11/16-16	6.5	6.5	22	21	33	63	<b>6-6F42EDMLOS</b>	<b>6-6F42EDMLOSS</b>	630	630
8, 10	5/16, 3/8	1/2-14	11/16-16	6.5	6.5	27	23	37	122	<b>6-8F42EDMLOS</b>	<b>6-8F42EDMLOSS</b>	420	420
8, 10	5/16, 3/8	3/4-14	11/16-16	6.5	16	32	24	40	192	<b>6-12F42EDMLOS</b>	<b>6-12F42EDMLOSS</b>	420	420
12	1/2	3/8-19	13/16-16	9.5	8	22	23	35	196	<b>8F42EDMLOS</b>	<b>8F42EDMLOSS</b>	630	630
12	1/2	1/4-19	13/16-16	9.5	5	22	26	38	193	<b>8-4F42EDMLOS</b>	<b>8-4F42EDMLOSS</b>	630	630
12	1/2	1/2-14	13/16-16	9.5	9.5	27	25	39	198	<b>8-8F42EDMLOS</b>	<b>8-8F42EDMLOSS</b>	420	420
12	1/2	3/4-14	13/16-16	9.5	9.5	32	26	42	205	<b>8-12F42EDMLOS</b>	<b>8-12F42EDMLOSS</b>	420	420
14, 15, 16	5/8	1/2-14	1-14	12.5	12.5	27	27	41	332	<b>10F42EDMLOS</b>	<b>10F42EDMLOSS</b>	420	420
14, 15, 16	5/8	3/8-19	1-14	12.5	8	27	31	43	315	<b>10-6F42EDMLOS</b>	<b>10-6F42EDMLOSS</b>	420	420
14, 15, 16	5/8	3/4-14	1-14	12.5	12.5	32	29	45	348	<b>10-12F42EDMLOS</b>	<b>10-12F42EDMLOSS</b>	420	420
14, 15, 16	5/8	1-11	1-14	12.5	12.5	41	30	48	360	<b>10-16F42EDMLOS</b>	<b>10-16F42EDMLOSS</b>	420	420
18, 20	3/4	3/4-14	1 3/16-12	15.5	15.5	32	30	46	200	<b>12F42EDMLOS</b>	<b>12F42EDMLOSS</b>	420	420
18, 20	3/4	1/2-14	1 3/16-12	15.5	12	32	35	49	183	<b>12-8F42EDMLOS</b>	<b>12-8F42EDMLOSS</b>	420	420
18, 20	3/4	1-11	1 3/16-12	15.5	15.5	41	32	50	362	<b>12-16F42EDMLOS</b>	<b>12-16F42EDMLOSS</b>	420	420
18, 20	3/4	1 1/4-11	1 3/16-12	15.5	16	50	34	54	505	<b>12-20F42EDMLOS</b>	<b>12-20F42EDMLOSS</b>	420	420
22, 25	1	1-11	1 7/16-12	20.5	20	41	32	50	343	<b>16F42EDMLOS</b>	<b>16F42EDMLOSS</b>	420	420
22, 25	1	1/2-14	1 7/16-12	20.5	12	41	36	50	380	<b>16-8F42EDMLOS</b>	<b>16-8F42EDMLOSS</b>	420	420
22, 25	1	3/4-14	1 7/16-12	20.5	16	41	36	52	411	<b>16-12F42EDMLOS</b>	<b>16-12F42EDMLOSS</b>	420	420
22, 25	1	1 1/4-11	1 7/16-12	20.5	20.5	50	34	54	487	<b>16-20F42EDMLOS</b>	<b>16-20F42EDMLOSS</b>	420	420
22, 25	1	1 1/2-11	1 7/16-12	20.5	20.5	55	36	58	715	<b>16-24F42EDMLOS</b>	<b>16-24F42EDMLOSS</b>	350	280
28, 30, 32	1 1/4	1 1/4-11	1 11/16-12	25	25	50	34	54	454	<b>20F42EDMLOS</b>	<b>20F42EDMLOSS</b>	420	280
28, 30, 32	1 1/4	3/4-14	1 11/16-12	26	16	46	37	53	362	<b>20-12F42EDMLOS</b>	<b>20-12F42EDMLOSS</b>	420	280
28, 30, 32	1 1/4	1-11	1 11/16-12	26	20	46	39	57	412	<b>20-16F42EDMLOS</b>	<b>20-16F42EDMLOSS</b>	420	280
28, 30, 32	1 1/4	1 1/2-11	1 11/16-12	26	26	55	36	58	532	<b>20-24F42EDMLOS</b>	<b>20-24F42EDMLOSS</b>	350	280
35, 38	1 1/2	1 1/2-11	2-12	32	32	55	36	58	585	<b>24F42EDMLOS</b>	<b>24F42EDMLOSS</b>	350	280
35, 38	1 1/2	1-11	2-12	32	20	55	41	59	471	<b>24-16F42EDMLOS</b>	<b>24-16F42EDMLOSS</b>	350	280
35, 38	1 1/2	1 1/4-11	2-12	32	25	55	41	61	540	<b>24-20F42EDMLOS</b>	<b>24-20F42EDMLOSS</b>	350	280

Product delivered with NBR TRAP seal. Replacement of TRAP seal is with a standard NBR O-ring – see page J74–J75.

Part numbers shown are part of our current manufacturing programme.

Imperial and metric parts may vary in hexagon dimensions.

$$\frac{\text{PN (bar)}}{10} = \text{PN (MPa)}$$

Do not create drawings from these dimensions, they are subject to change and ISO manufacturing allowances.