

MAV...MA3 - MAVMD...MA3 - SMA3

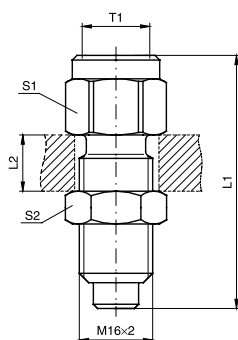

Pressure gauge connector:
MAV...MA3

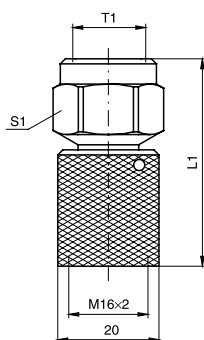

Gauge-Direct-Connector:
MAVMD...MA3

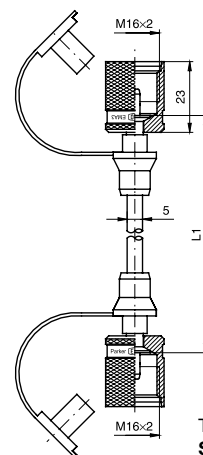

Test hose:
SMA3

| T1 | L1 | L2 max. | S1 | S2 | Weight g/1 piece | Order code | PN (bar) CF | DF** |
|-------|--------|---------|----|----|---------------------|--------------------|----------------|------|
| G 1/4 | 54.0 | 12 | 19 | 19 | 74 | MAV1/4MA3 | 630 | 4.0 |
| G 1/2 | 64.0 | 12 | 27 | 19 | 129 | MAV1/2MA3 | 630 | 4.0 |
| G 1/4 | 41.0 | | 19 | | 61 | MAVMD1/4MA3 | 630 | 4.0 |
| G 1/2 | 51.5 | | 27 | | 103 | MAVMD1/2MA3 | 630 | 4.0 |
| | 200.0 | | | | 73 | SMA3-200 | 630 | 2.5 |
| | 300.0 | | | | 74 | SMA3-300 | 630 | 2.5 |
| | 400.0 | | | | 74 | SMA3-400 | 630 | 2.5 |
| | 630.0 | | | | 79 | SMA3-630 | 630 | 2.5 |
| | 800.0 | | | | 83 | SMA3-800 | 630 | 2.5 |
| | 1000.0 | | | | 87 | SMA3-1000 | 630 | 2.5 |
| | 1500.0 | | | | 95 | SMA3-1500 | 630 | 2.5 |
| | 2000.0 | | | | 105 | SMA3-2000 | 630 | 2.5 |
| | 2500.0 | | | | 110 | SMA3-2500 | 630 | 2.5 |
| | 3200.0 | | | | 125 | SMA3-3200 | 630 | 2.5 |
| | 4000.0 | | | | 137 | SMA3-4000 | 630 | 2.5 |

| Order code suffixes | | | |
|---------------------|-----------------|--|--|
| | Stainless Steel | | |
| Suffix | 71 | | |
| Example | MAV1/4MA371 | | |