

**DG 105 - Double elbow ball bearing rotary union**

EO 24° cone end / EO 24° cone end

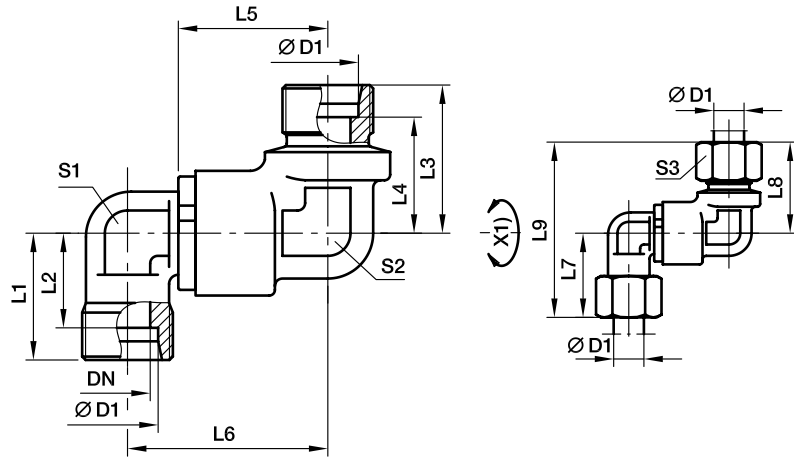

X1) Axis

Series	Ø D1	DN	L1	L2	L3	L4	L5	L6	L7	L8	L9	S1	S2	S3	Weight g/1 piece	Order code	
S	12	9.5	39.5	26.5	43	21.5	38	81	53.0	24	22	24	29	50.5	384	<b>DG105/12S</b>	Pressure ratings see chart 1
	16	9.5	39.5	25.5	44	24.5	43	87	53.0	30	22	24	33	52.5	377	<b>DG105/16S</b>	
	20	16.0	56.5	39.5	61	26.5	48	109	76.0	36	36	32	37	71.5	1015	<b>DG105/20S</b>	
	25	16.0	56.5	38.0	62	30.0	54	116	76.0	46	36	32	42	74.0	1034	<b>DG105/25S</b>	
	30	26.0	65.0	44.5	71	35.5	62	133	92.5	50	50	50	49	84.5	2344	<b>DG105/30S</b>	
	38	26.0	65.0	42.0	73	41.0	72	145	92.5	60	50	50	57	89.0	2485	<b>DG105/38S</b>	